

AD901B Assembly Guide

Before Assembling:

1. Please check the accessory list before assembly. Contact your local dealer if you find any parts missing.
2. Please read through the assembly guide.

PCI-e Standard bracket

AD901B Adapter

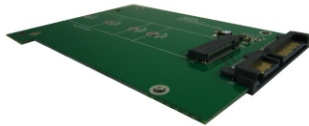

Accessory Package

(1)M3x5 Screw *1pc P/N: 13MISW00005M11		[for M.2 NGFF SSD]
(2)M3 Nut *1pc P/N: 13MINU00002M11		[for M.2 NGFF SSD]
(3)Copper Nut /H: 1.45mm *1pc P/N: 13MICA00001M05		[for M.2 NGFF SSD]
(4)M3x5 Screw *3pcs P/N: 13MISW00004M11		[for PCI-e Bracket]

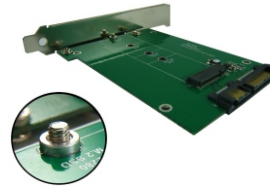

Step 1

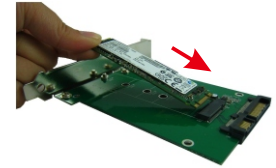

Step 2

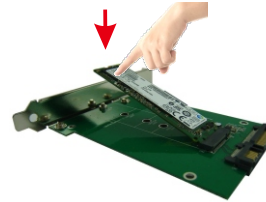

Step 3

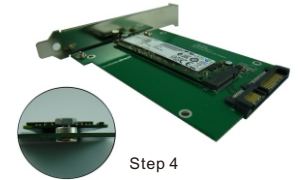

Step 4

Step 1: Put copper nut on the same side of the NGFF connector; and screw M3x5mm screw from bottom to top of the adapter.

Step 2: Insert M.2 NGFF SSD into M.2 67pin socket. (Figure 2)

Step 3: Press down M.2 NGFF SSD and aim to the copper nut hole. (Figure 3)

Step 4: Using M3 nuts to fix M.2 NGFF SSD on the adapter (Figure 4), namely complete the installation.